



TECHNICAL DATA / FEATURES

dimensions: 172x142x77
 light functions: passing, driving, position
 function markings: C/R, A, HC/R
 traffic: right-hand
 reference mark: 12.5, 17.5
 source of light: R2, T4W, H4
 maximum power: 55/50W, 4W, 75/70W
 nominal voltage: 12V-24V DC
 optics: standard
 IP rating: IP54
 housing's material: plastic
 lens' material: glass
 built-in connectors: -



ADDITIONAL INFORMATION

Particularly recommended for tractors and slow-moving vehicles.

To be mounted in factory designed locations or in the front bumper recesses.

Useful parts while installing:

- main bulb gasket - cat. No. A.05820
- position light bulb holder - cat. No. A.05921
- main bulb mounting block - cat. No. A.07128

Dedicated application:

A - tractors:

- Case IH: 433, 743, 745
- Fendt: 360, 365, 380, 390, 395
- Fendt Farmer: 303-312
- Fendt Favorit: 610, 611, 612, 614, 615, 626
- Zetor: 4340, 5320, 6320, 7340 (until 1999)

A - slow-moving vehicle Atlas 1404

B - tractors:

- Case IH: 383, 423, 453, 554, 644, 744, 844, 846, 1046, 1246
- Fendt: 1Z, 1E, 1D, 2DE, 2E, 2S, F1X 2
- Fendt Farmer: 102-108, 200-205
- Steyr: 8060, 8070, 8080, 8100, 8120, 8140, 8160
- Mercedes-Benz: MB-Trac: 700, 800, 900, 1000, 1100, 1300, 1500

DIMENSIONS

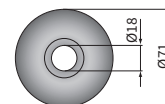
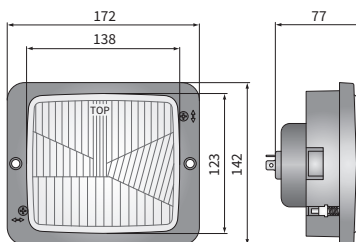

A.05820

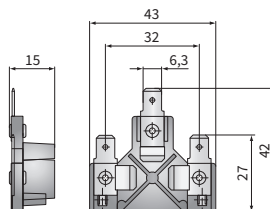

A.07128

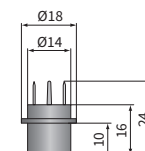

A.05921

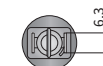

Cat. number	Hella Catal. No.	Homologation code	Light functions			Type	R2	H4	Reference mark	12,5	17,5	Accessories			Side	right	left	Application	dedicated	Packaging / pc	carton box
			passing	driving	position							bulb H4 12V	bulb T4W	frame							
RE.22788	1AA 004 109-001	012	✓	✓		✓			✓						✓	✓		A		1	
RE.22778	1AA 004 109-031	012	✓	✓	✓	✓			✓						✓	✓		A		1	
RE.22779	1AB 001 100-001	012	✓	✓	✓	✓			✓						✓	✓		B		1	
RE.22889	1AA 004 109-021	009	✓	✓			✓		✓	✓					✓	✓		A		1	
RE.22879	1AA 004 109-041	009	✓	✓	✓		✓		✓	✓					✓	✓		A		1	
RE.22880		009	✓	✓	✓		✓		✓	✓					✓	✓		A		1	
RE.22780		009	✓	✓	✓		✓		✓	✓					✓	✓				1	